

AUSTIN VILLAGE CONSERVATION AREA NO.30



DATE OF DESIGNATION
17TH JULY 1997

AREA 13.26 Ha. (32.77 Acres)

- BOUNDARY OF CONSERVATION AREA
- STATUTORILY LISTED BUILDINGS
- LOCALLY LISTED BUILDINGS
- ARTICLE 4 (2) DIRECTION



Scale 1:3000



Planning Management
PO Box 28
Birmingham, B1 1TU.
Tel: 0121 303-1115

E mail planning_conservation@birmingham.gov.uk

www.birmingham.gov.uk

MAP PRODUCED BY GIS TEAM, STRATEGIC PLANNING

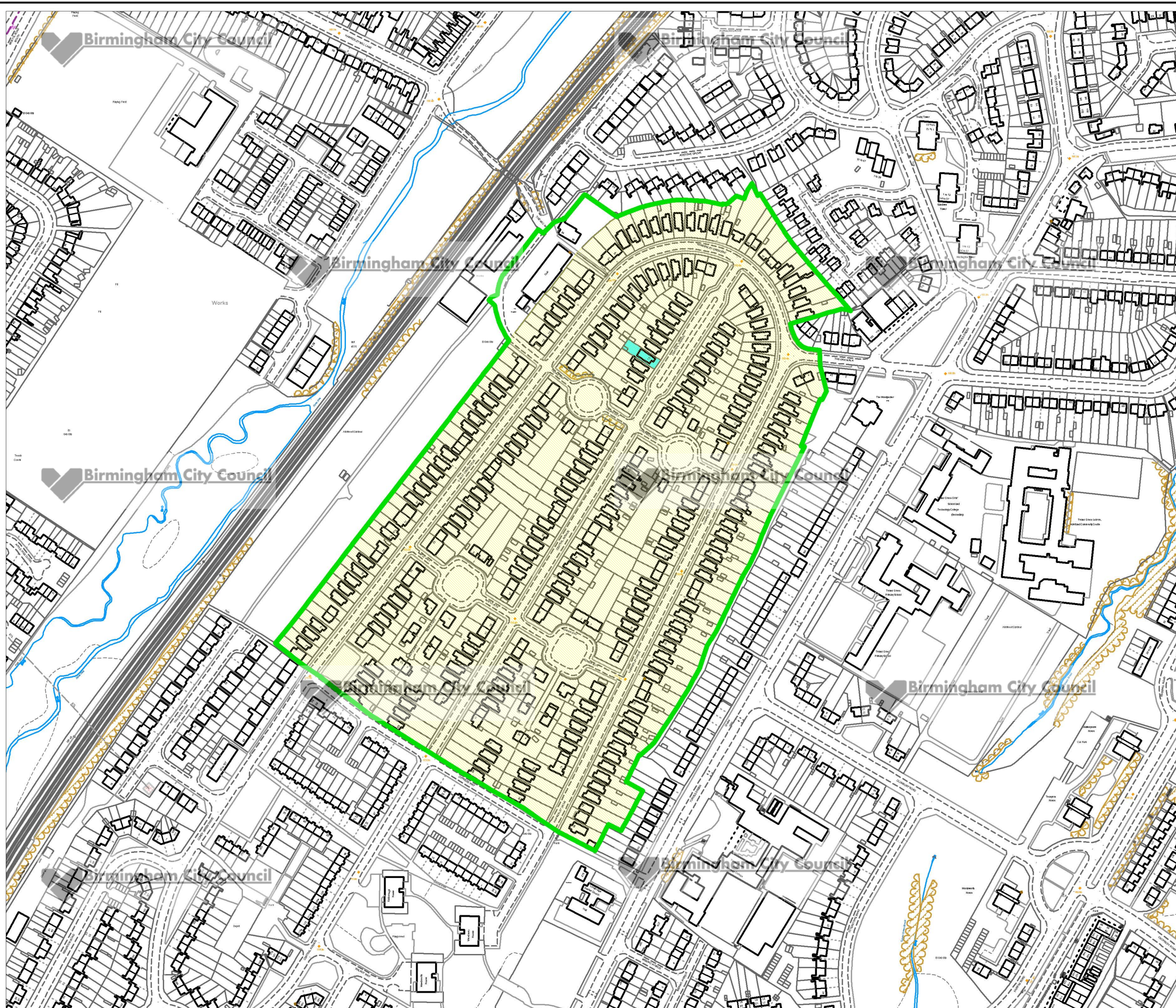

This map is reproduced from the Ordnance Survey Material with the permission of Ordnance Survey on behalf of the Controller of Her Majesty's Stationery Office © Crown Copyright.
Unauthorised reproduction infringes Crown Copyright and may lead to prosecution or civil proceedings. Birmingham City Council. Licence No.100021326, 2011