

STATUTORY DECLARATION

I, MICHAEL ROBERTS, Honorary Secretary to Walmley Golf Club (Wylde Green) Limited ("Golf Club") do solemnly and sincerely declare as follows:

- 1. I make this statutory declaration in accordance with the provisions of the Highways Act 1980 section 31 sub-section (6).
- 2. The Golf Club is and has been since 30 September 1982 the owner of the land known as Walmley Golf Club.
- 3. On 30th September 2001 I, on behalf of the Golf Club, deposited with Birmingham City Council, being the appropriate Council, a statement accompanied by a map delineating the Golf Club's property by red edging which stated that the ways coloured purple on the said map have been dedicated as footpaths and no other ways have been dedicated as highways over the Golf Club's property.
- 4. No additional ways have been dedicated over the land shown edged red on the said map since the statement dated 30th September 2001 and at the present time the Golf Club has no intention of dedicating any more public rights of way over its property.

AND I MAKE this solemn declaration on 7 October 2001 conscientiously believing it to be true and by virtue of the provisions of the Statutory Declarations Act 1835.

DECLARED AT WALMLEY GOLF CLUB
BROOKS ROAD
SUSTON COLDFIELD B72 1HR



Before me
J. E. Oerli,
(Commissioner for Oaths or a Justice of the Peace or Solicitor)

DEPOSIT OF STATEMENT AND MAP

SECTION 31(B) OF THE HIGHWAYS ACT 1980

To Birmingham City Council

1. Walmley Golf Club (Wylde Green) Limited is and has been since 30 September 1982 the owner of the land known as Walmley Golf Club more particularly delineated on the Map accompanying this statement and thereon edged red.
2. The aforementioned land lies in the Parish of Sutton Coldfield.
3. The way coloured purple on the said Map has been dedicated as a footpath.
4. No other ways over the land have been dedicated as highways.
5. The deposit shall comprise this statement and the accompanying Map.

Signed: )
)

Date: 30. 9. 2001)

Full Name:) MICHAEL .J. ROBERTS

Address:) WALMLEY GOLF CLUB
) BROOKS ROAD
) WYLDE GREEN, SUTTON COLDFIELD
B72 1HR.

Occupation:) RETIRED

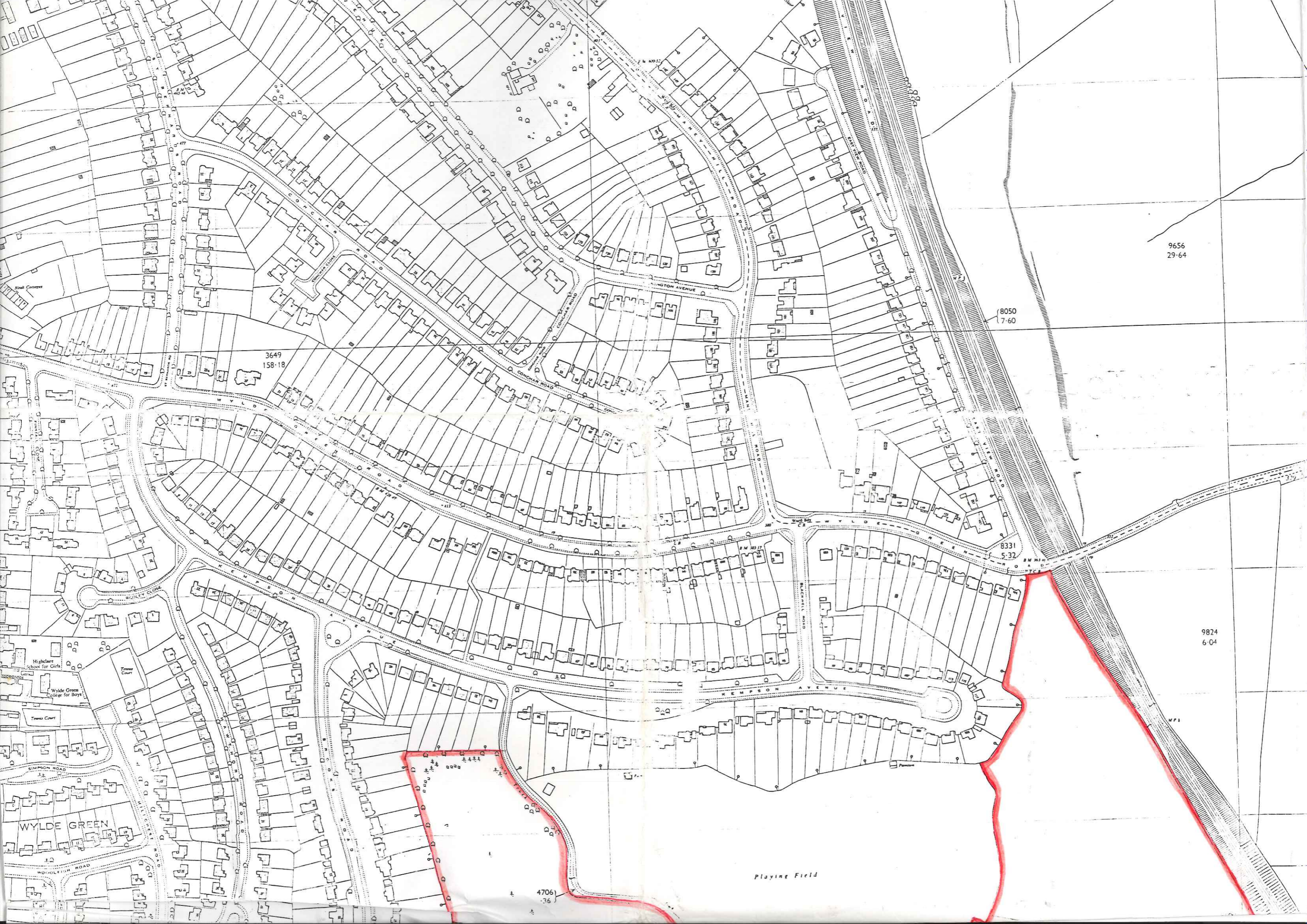

3649
158-18

8050
7-60

8331
5-32

9656
29-64

9824
6-04

4706
1-36

WYLDE GREEN

Playing Field

Highclare
School for Girls

Wylde Green
College for Boys

Tennis Court

SIMPSON ROAD

WYLDEN ROAD

4 APR 22

14 APR 22

MPI

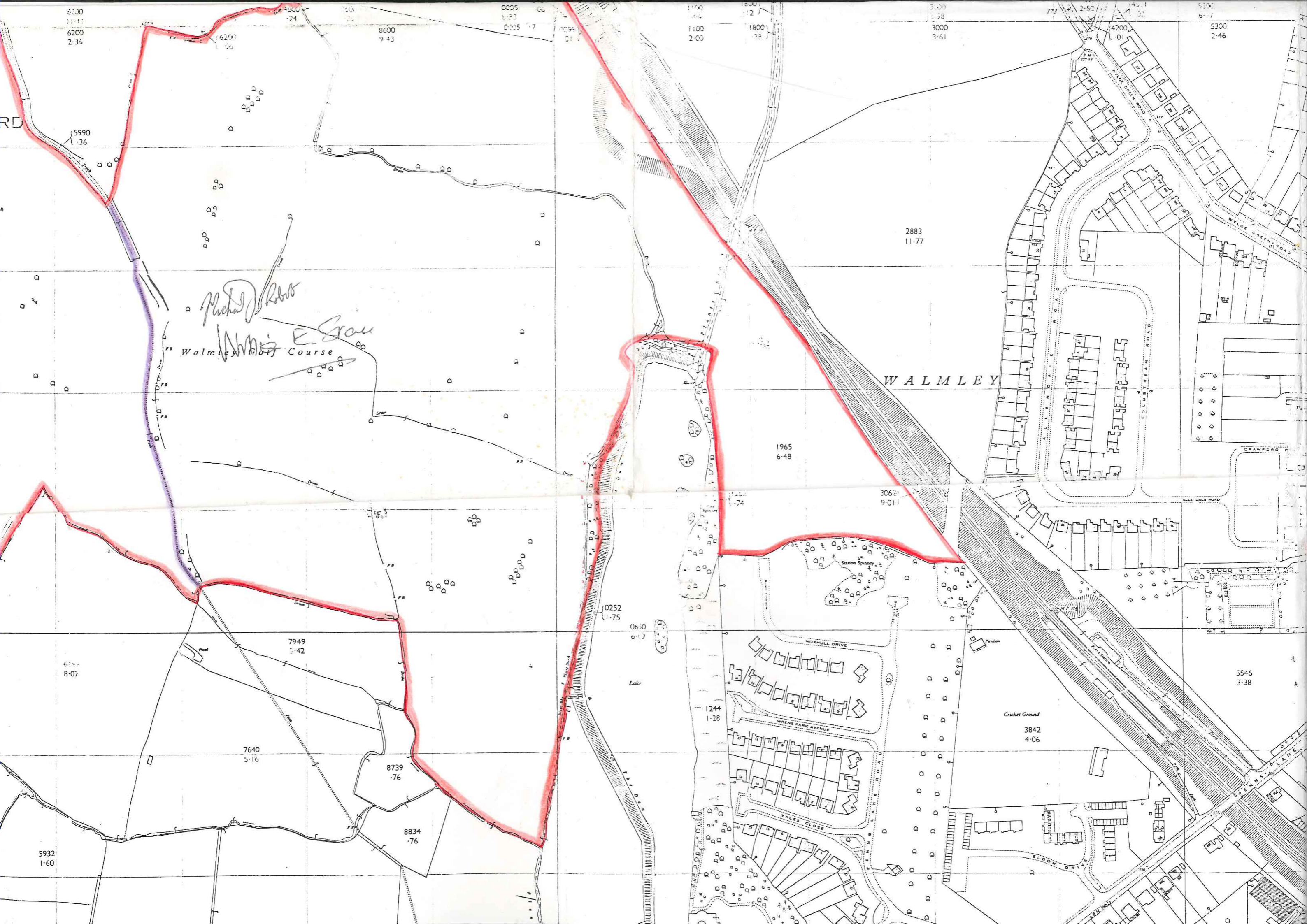

Wm E. Gray
Walmley Golf Course

WALMLEY

2883
11-77

1965
6-48

3062
9-01

10252
1-75

06-10
6-17

Lake

1244
1-28

Cricket Ground
3842
4-06

5546
3-38

7949
2-42

7640
5-16

8739
-76

8834
-76

5932
1-60

8-07

6200
2-36

6200

8600
9-43

6005
5-23

6099
0-15

1100
2-00

1800
1-12

3000
3-61

4200
-01

5300
2-46

RD

5990
-36

CRAWFORD

ALLE DALE ROAD

MORHULL DRIVE

WRENS PARK AVENUE

VALES CLOSE

Cricket Ground

3842

4-06

5546

3-38

7949

2-42

7640

5-16

8739

-76

8834

-76

5932

1-60

8-07

6200

2-36

6200

8600

9-43

6005

5-23

6099

0-15

1100

2-00

1800

1-12

3000

3-61

4200

-01

5300

2-46

WYLDE GREEN WARD

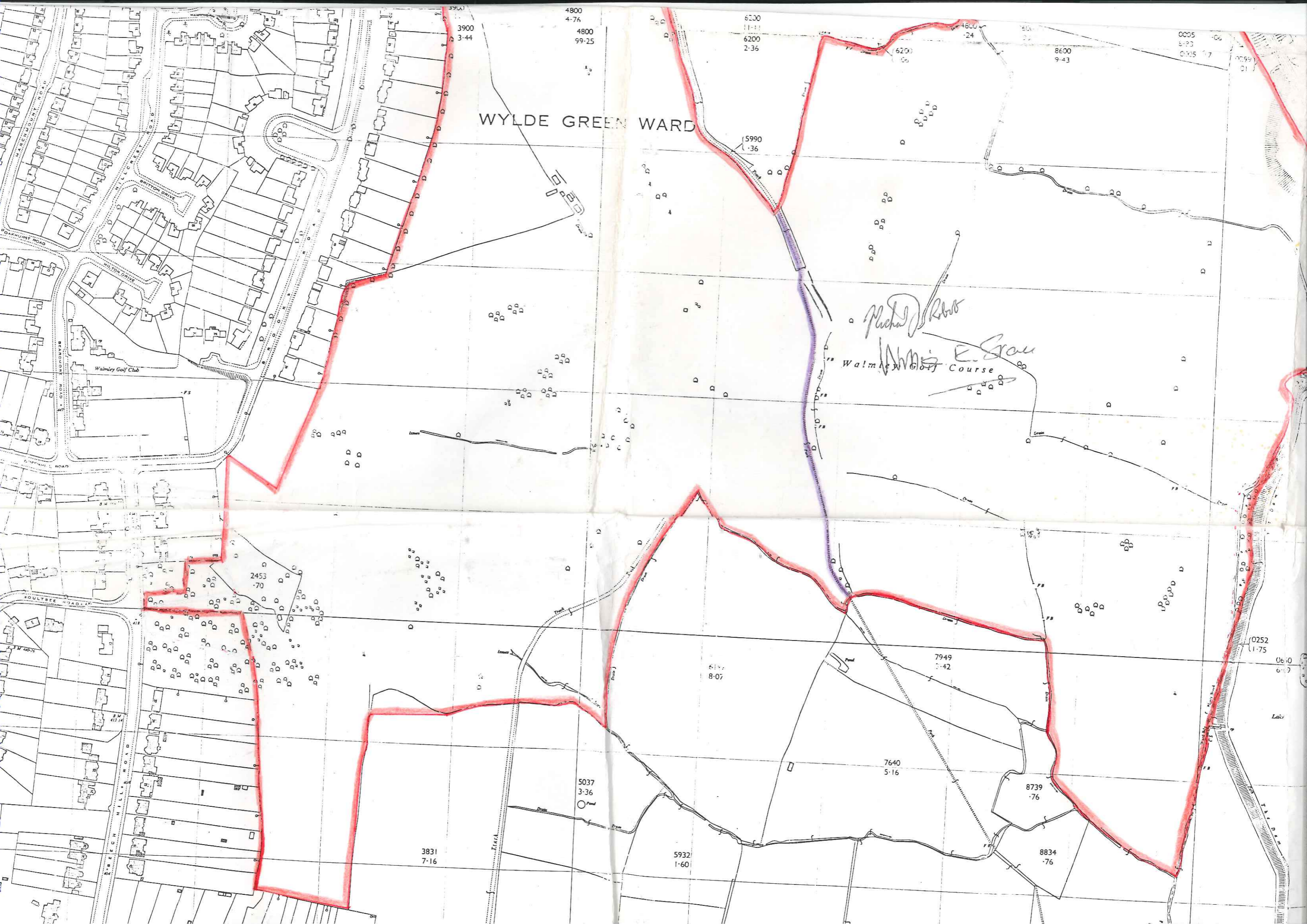

Richard Roberts
John E. Gray
Walmley Golf Course

3900
3-44

4800
4-76
4800
99-25

6200
1-11
6200
2-36

4800
2-24

8600
9-43

0005
8-23
0005
1-7

1099
1-01

5990
1-36

2453
7-70

5037
3-36

5932
1-60

7640
5-16

7949
2-42

8739
7-76

8834
7-76

10252
1-75

3831
7-16

0610
6-7