

FILE PATH - X:\ACAD\dwg\std\Detail Drawings\Current\Series 3000\Drawg\HW-3.05 RevG Bow Top Vertical Bar Fence.dwg

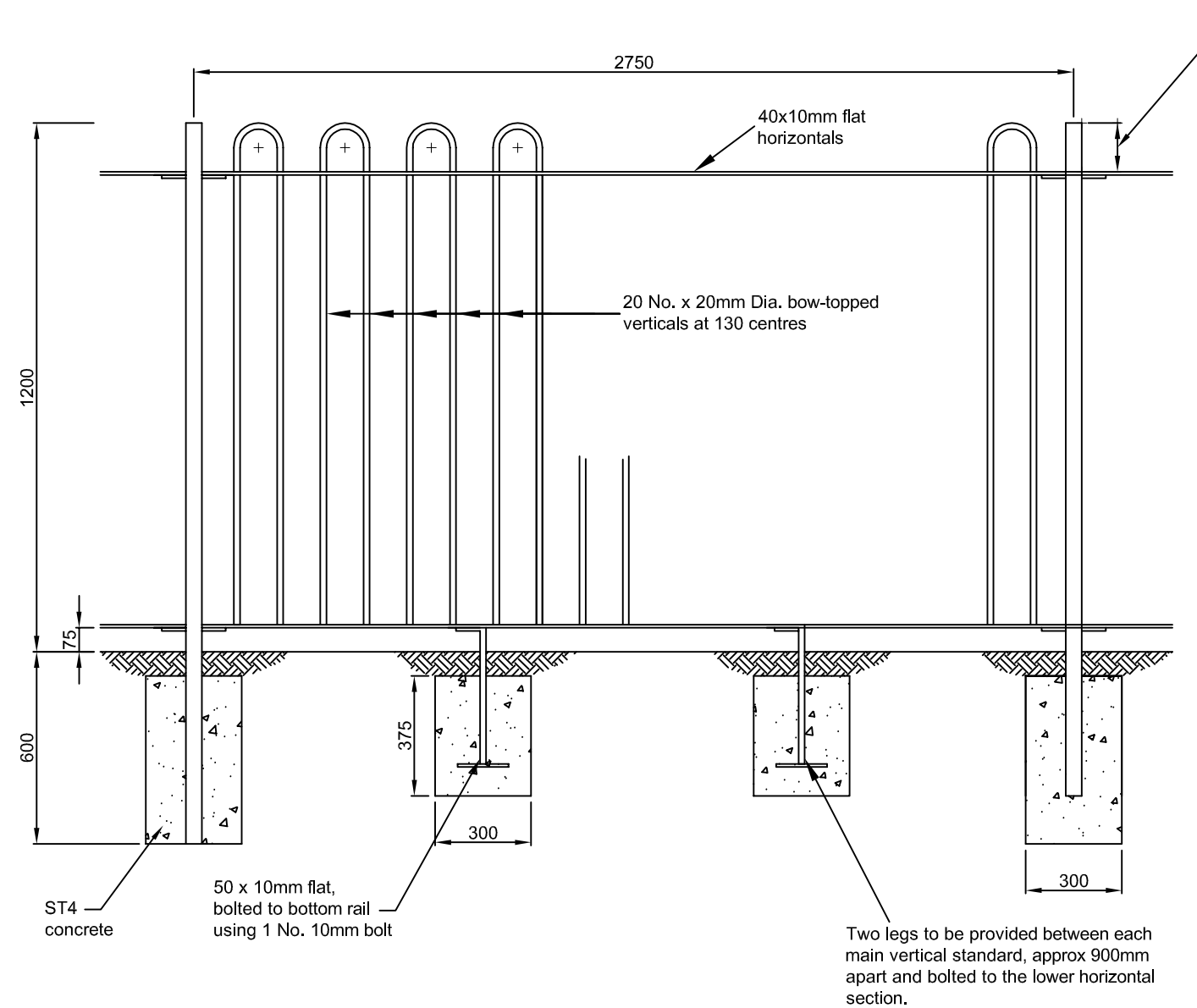

**FRONT ELEVATION**

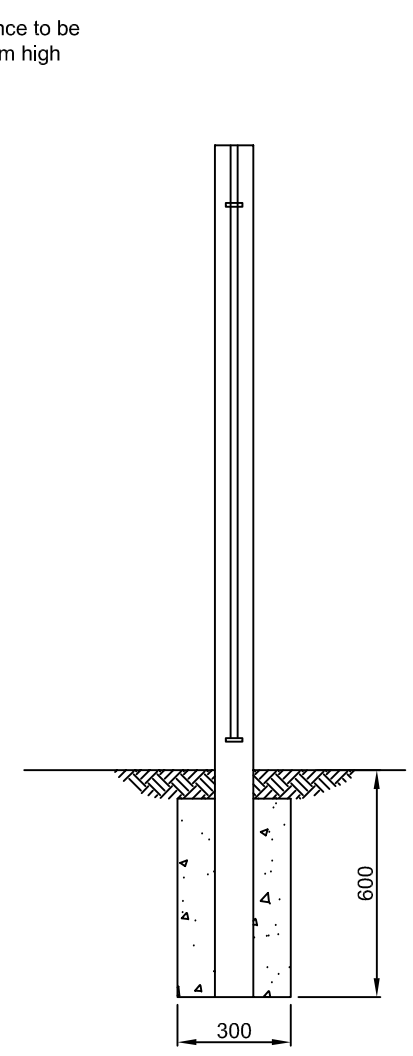

**SIDE VIEW**

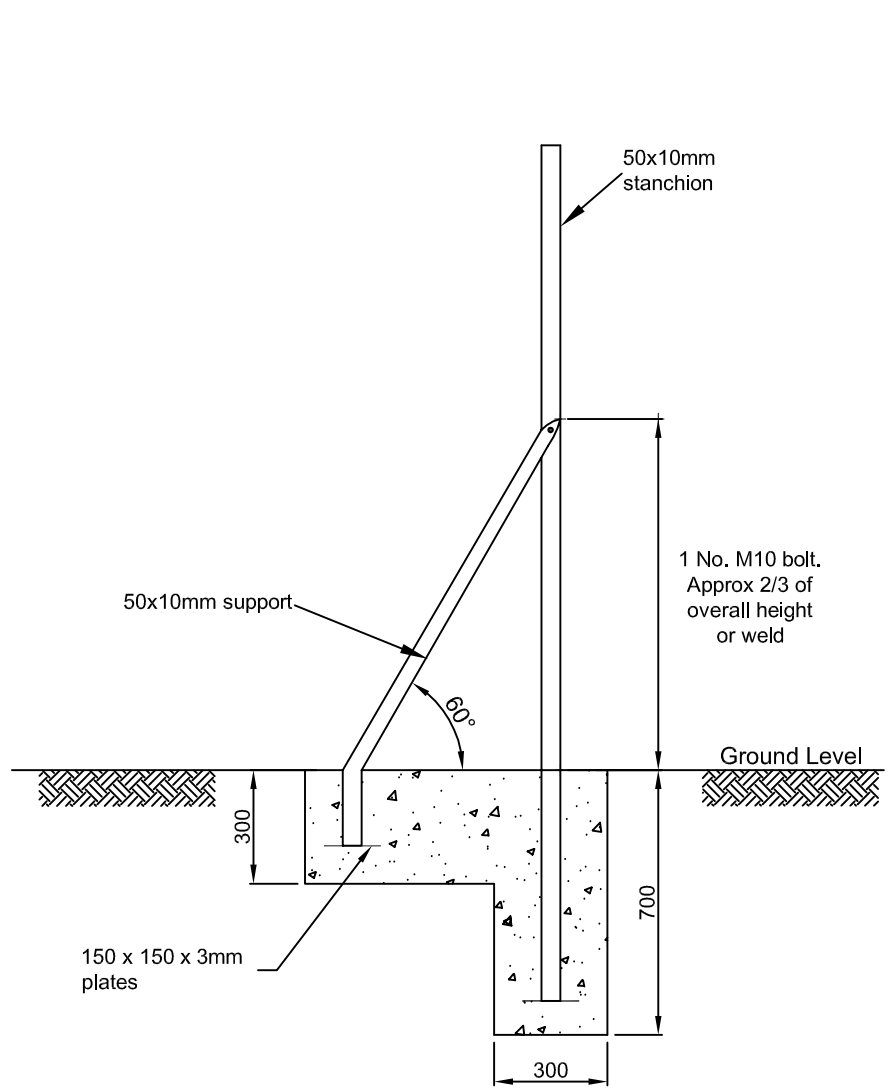

**ALTERNATIVE TYPICAL SIDE VIEW (WITH SUPPORT)**

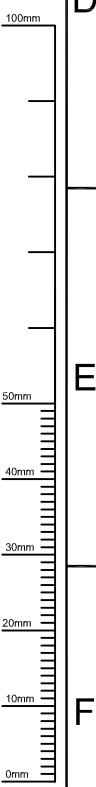

- Notes:**
- All metal parts to be Mild Steel Grade 43C, hot-dip galvanised to BS EN ISO 1461. Welds to be 5mm to BS EN 1011-2; surface welds to be cleaned flush.
  - Fence to be in accordance with BS 1722-9.
  - Fishplates to be 6mm thick, connected with 10mm dia. bolts.
  - Corner posts shall be provided at each change in direction, to be 50 x 50 x 6mm RSA for fences up to 1400mm high and 70 x 70 x 6mm RSA for fences over 1400mm high.
  - See Appendix 3/1 and 19/5 for painting requirements.
  - Non-Standard and end panels shall be fabricated after measurement on site if necessary.
  - All dimensions in millimetres.

**Birmingham City Council**

FS 506677

SCHEME  
STANDARD DETAIL SHEETS

DRAWING  
BOW TOP VERTICAL BAR FENCE

This detail is controlled by Birmingham City Council. Email - Transport.Projects@Birmingham.gov.uk

2015	G	NOTES AMENDED	DH	TE
2015	F	NOTES AMENDED	DH	PP
2014	E	DETAILS AMENDED	DH	PP
2013	D	DETAILS & FRAME AMENDED	DH	PP
2009	C	NOTES AMENDED	PAS	SBM
2004	B	NOTES AMENDED	-	AJC
2002	A	BORDER & TITLE AMENDED	-	AJC
2000	-	ORIGINAL DRAWING CREATED	SRE	AJC
DATE	REV.	REVISIONS	DRN	PM
DRAWN	DESIGNER	PM	REVISION	
DH	TE	PP	G	
03/12/13	03/12/13	03/12/13		
DRAWING STATUS				SCALE
GENERAL				1:20
DWG. No				
HW/3.05				